

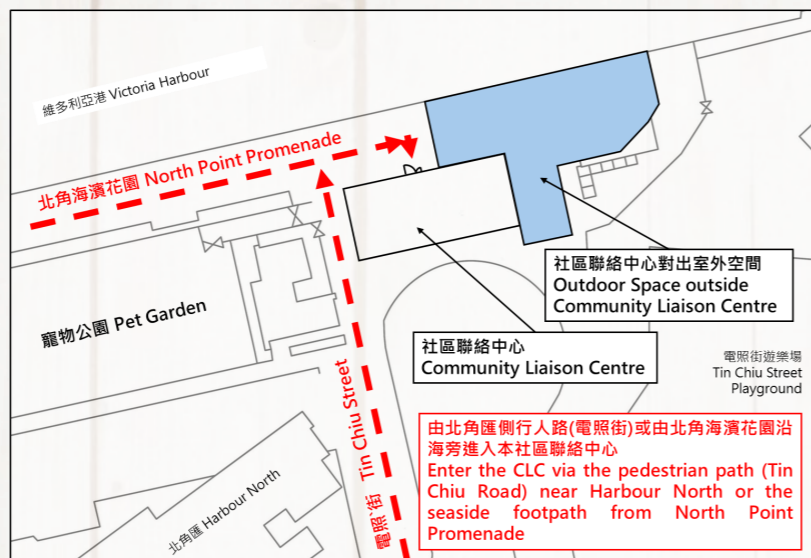

社區聯絡中心優化工程 Enhancement of Community Liaison Centre!

為舉辦更多展覽及社區聯絡活動，本社區聯絡中心及對出室外空間將會進行優化工程。室外空間(右圖藍色部份)將會由2024年4月29日起關閉以進行優化，屆時公眾人士可由北角匯側行人路(電照街)或由北角海濱花園沿海旁進入本社區聯絡中心。而本社區聯絡中心則預計於2024年5月9日起暫時關閉以進行內部優化。本社區聯絡中心及對出室外空間預計於2024年6月上旬重新開放。不便之處，敬請見諒。



The Community Liaison Centre (CLC) and the adjacent outdoor space will undergo enhancement works for coming exhibitions and community engagement activities. The outdoor space (indicated by the blue area in the diagram above) will be closed for enhancement works starting from 29 April 2024. During the closure of the outdoor area, the public can walk along the pedestrian path (Tin Chiu Road) near Harbour North or the seaside footpath from North Point Promenade to enter the CLC. The CLC itself will be temporarily closed for interior enhancement works starting from 9 May 2024 tentatively. The CLC and the outdoor space will reopen in early June 2024. We apologize for any inconvenience caused.

社區聯絡中心開放時間 Opening Hours of Community Liaison Centre

- 星期二、四、五及日：早上8時至下午6時
- 星期三及六：早上11時至下午9時
- 星期一及法定假期：休息
(中心室外範圍：全天候開放予公眾享用)
- Tuesday, Thursday, Friday & Sunday: 8am-6pm
- Wednesday & Saturday: 11am-9pm
- Monday & Statutory Holidays: off
(Outdoor Area: 24/7 opens for public enjoyment)



聯絡我們 Contact Us

如對「東區走廊下之行人板道」有任何意見，歡迎提出。
Your comments on "Boardwalk underneath Island Eastern Corridor" are welcome.

24/7 9229 9843 spro@sd202102.com.hk

到訪工程網站了解更多資訊
Please visit our website for more information

<https://www.boardwalk.gov.hk/>



網上意見書
Online Comment Box
(掃描二維碼)
(Scan QR Code)



歡迎參閱「東區走廊下之行人板道」工程通訊
Welcome to the Project Newsletter of "Boardwalk underneath Island Eastern Corridor"

第5期
Issue 5 2024/04

「展翅翱翔」的開合橋 Movable Bridges "Flying Freely"

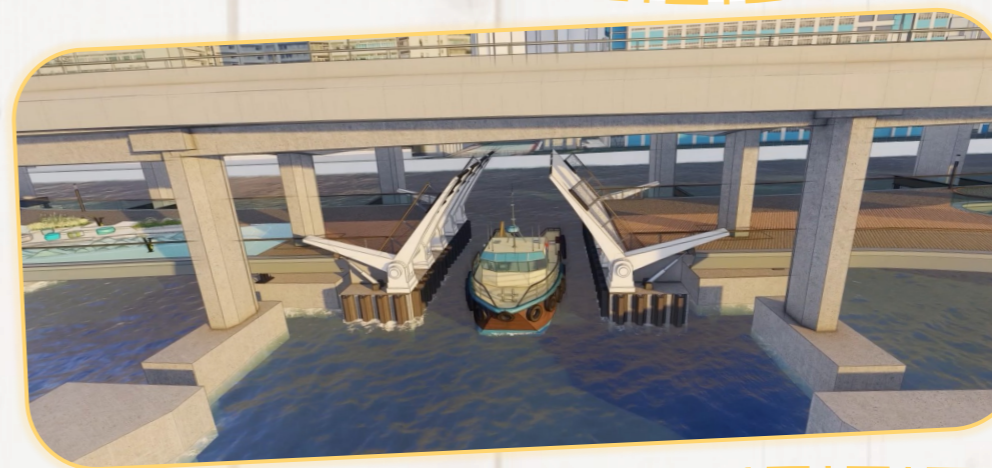

為配合海上航道的交通要求，我們分別會在淘·童夢之園及演·藝創長廊段興建兩條開合橋。日後在有需要時，開合橋會開啟，船隻便可進入近岸水域。兩條開合橋的設計意念乃取材自展翅翱翔於維港天際的海鳥。

淘·童夢之園段的一號開合橋 Movable Bridge No.1 in the Play Wave Section

In order to comply with the marine traffic requirements in the fairways, we are constructing two movable bascule bridges in the Play Wave section and the Art Wave section respectively. In future, vessels can enter the offshore waters after the movable bridges open. The design concept for these movable bascule bridges was inspired by birds flying freely above Victoria Harbour.

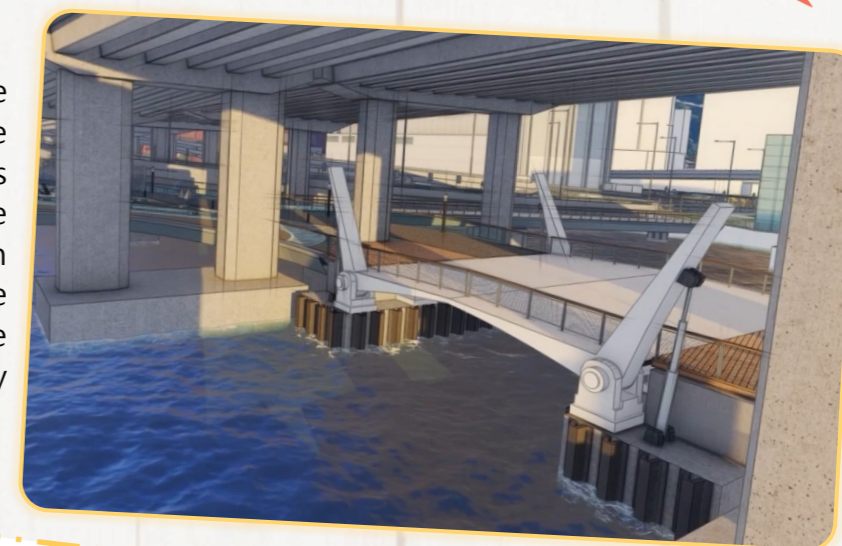

演·藝創長廊段的二號開合橋 Movable Bridge No.2 in the Art Wave Section





西段板道 Western Boardwalk

Western Boardwalk deck installation near City Garden progressing in full swing
近城市花園的西段板道安裝工程正進行得如火如荼



Piling works for Movable Bridge MB No.1 in progress
1 號開合橋
海上樁柱工程進行中



Piling works for Link Bridge LB No.1 in progress
1 號連接橋
海上樁柱工程進行中

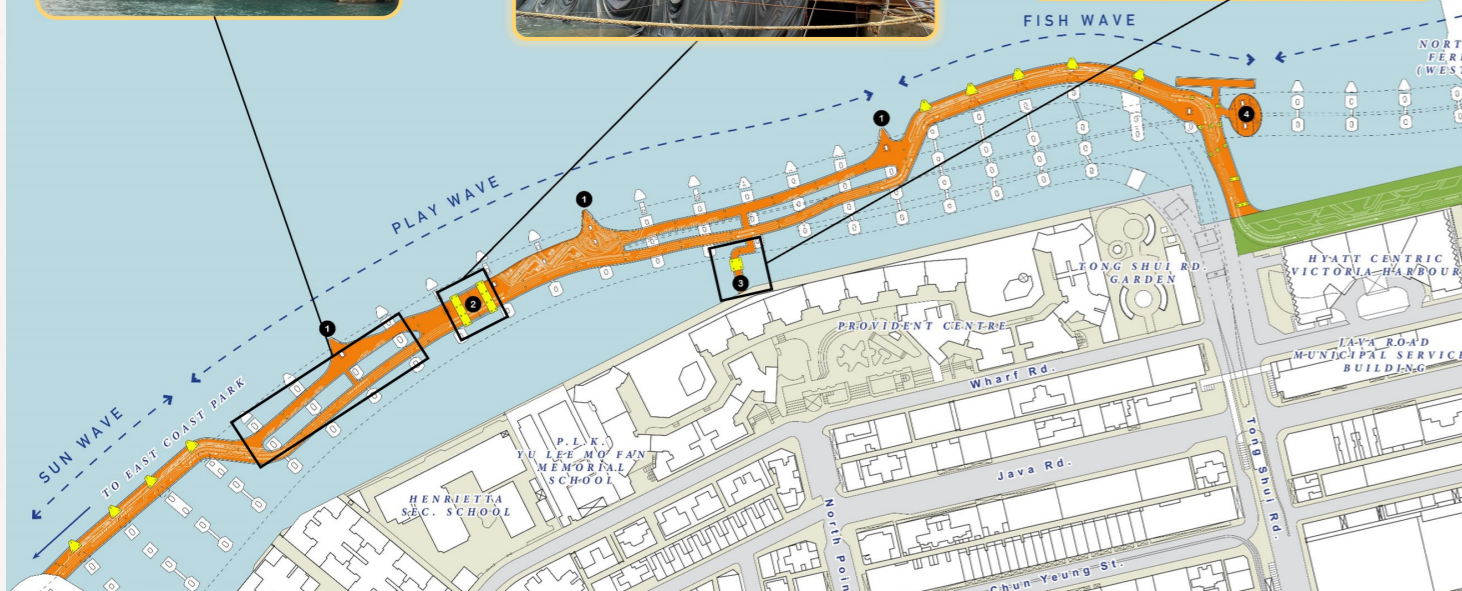

糖水道碼頭
Tong Shui Road Pier



近糖水道碼頭連接橋的海上樁柱工程正進行中
Marine piling works near Tong Shui Road Pier Access Bridge in progress

東段板道 Eastern Boardwalk



近北角政府合署的板道組件已安妥
Installation of Boardwalk deck segments near North Point Government Offices completed

北角海濱花園 North Point Promenade

為配合行人板道的活化工程，現有的北角海濱花園需以分階段臨時局部圍封，第一階段 B、第二階段及第三階段的工程(分別是紅色、黃色及紫色部份)現正進行中，而第四階段預計於本年七月展開。

To facilitate the revitalization works of the Boardwalk, the existing North Point Promenade is required to be partially closed on a temporary basis. The arrangement will be carried out in phases. The works for Stage 1B, Stage 2 and Stage 3 (shaded in red, yellow and purple parts respectively) are in progress. Stage 4 will commence later in July 2024.

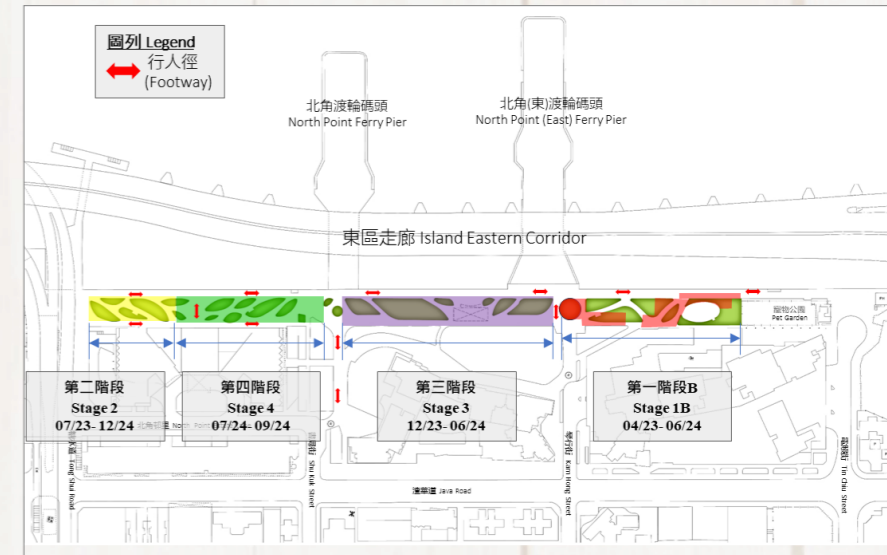

2023/11/22 顯理中學 Henrietta Secondary School

學校及社區團體到訪社區聯絡中心
Visit to Community Liaison Centre by Schools and Community Groups



2023/12/23 香港高等教育科技學院
Technological and Higher Education Institute of Hong Kong (THEi)



2023/12/23 香港專業進修學校
Hong Kong College of Technology



2024/01/06 路德會賽馬會富善綜合服務中心
Jockey Club Fu Shin Lutheran Integrated Service Centre